

PRELIMINARY NOT FOR CONSTRUCTION

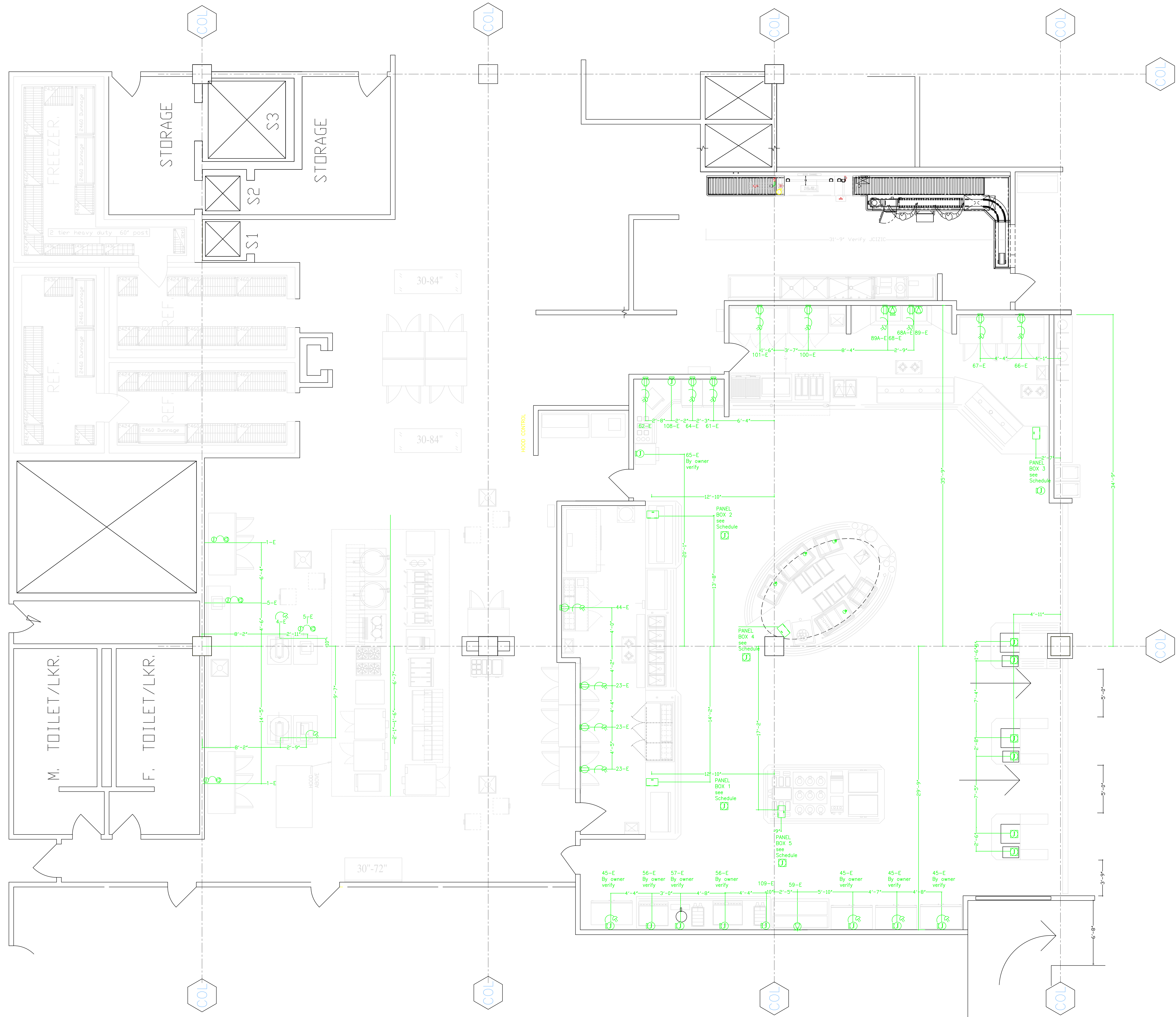

The design, drawings and/or specifications submitted herewith (the design) shall remain the sole property of REGISTER EQUIPMENT CO. INC. (Register). Reproduction or other use of the design without Register's prior written consent is prohibited. The design is accurate in all material respects. THIS SHALL CONSTITUTE REGISTER'S ENTIRE WARRANTY EXPRESS OR IMPLIED, INCLUDING BUT NOT LIMITED TO THE USE OF MERCHANTABILITY OR FITNESS FOR A PARTICULAR PURPOSE. In particular, Register makes no warranty as to the subjective aspects of the design, the use of which is the customer's decision. In addition, Register is not responsible for the accuracy of any information provided by others, including but not limited to, the architect, engineer, contractor, or other sources. The validity of any information provided by others shall remain the responsibility of the user. Register is not responsible for any information in which the design is based, in whole or in part, on information or data provided by any other source, firm, or individual, or on information or data provided by any other source, firm, or individual.

CHILDRENS HOSPITAL WASHINGTON DC
REGISTER EQUIPMENT COMPANY, Inc.
 17466 RITTS Road Emmelburg, MD Phone: 501-447-9990 Fax: 501-447-6506 MBS@randa.com

Sheet Number	Project Number	Equipment	Document Release
KP-1	CHI-001	EQUIPMENT PLUMBING ROUGH IN DRAWING	
	Scale: 1/4" = 1'		
	Drawn: Michael Register		
	Date:		